

## Getting to know the HM6000<sup>[2]</sup>

— Your new Bluetooth circuit controller.<sup>[3]</sup>

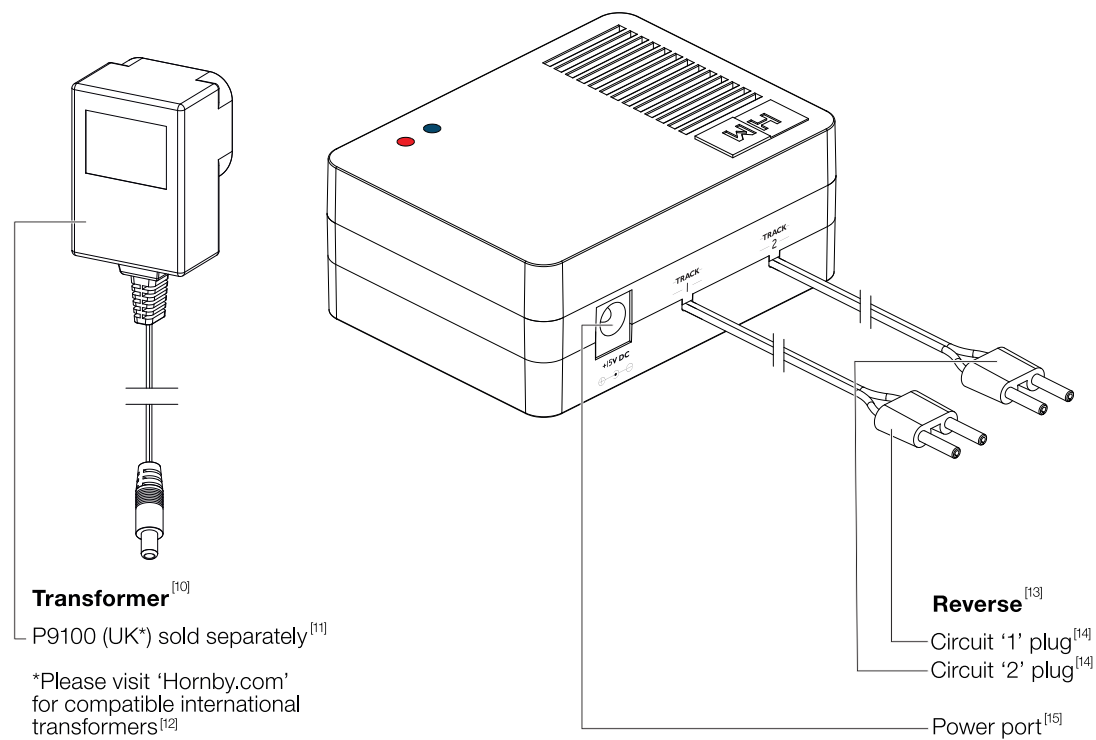
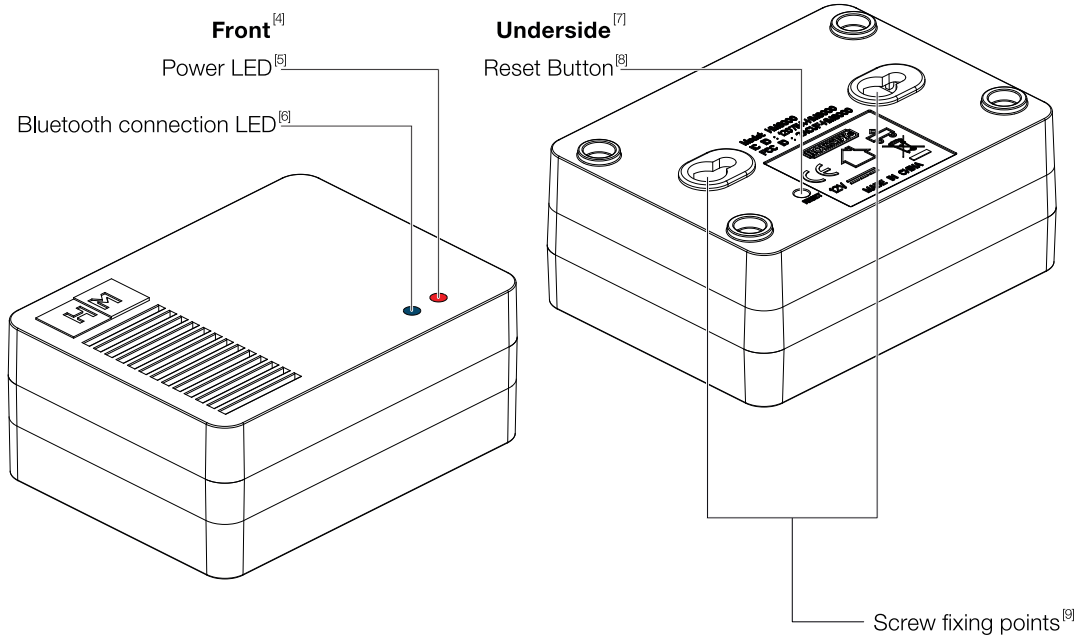

## Initial setup<sup>[16]</sup>

— Your quick step guide<sup>[17]</sup>

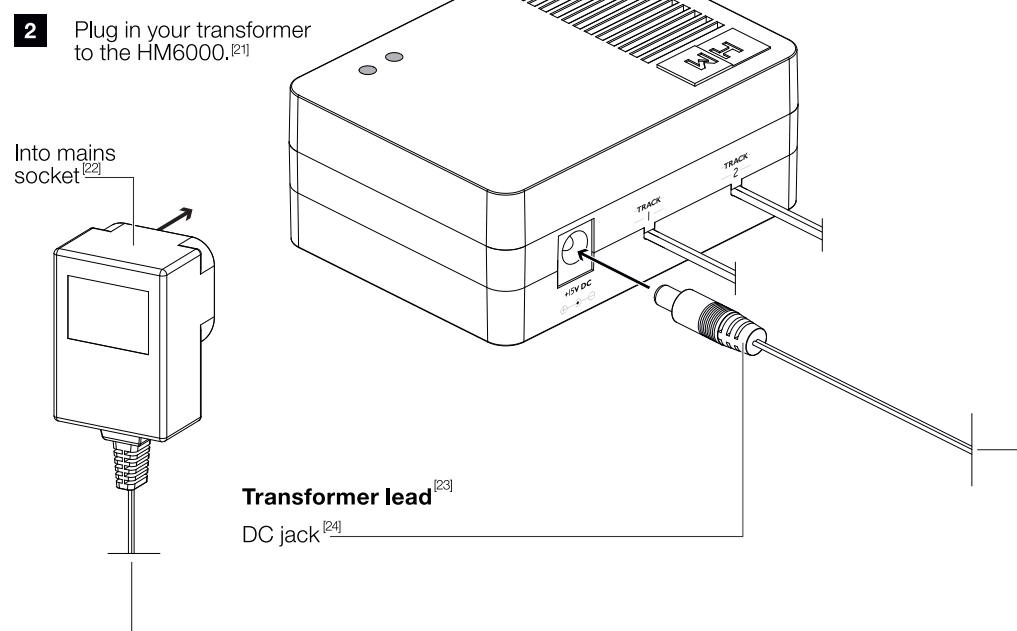
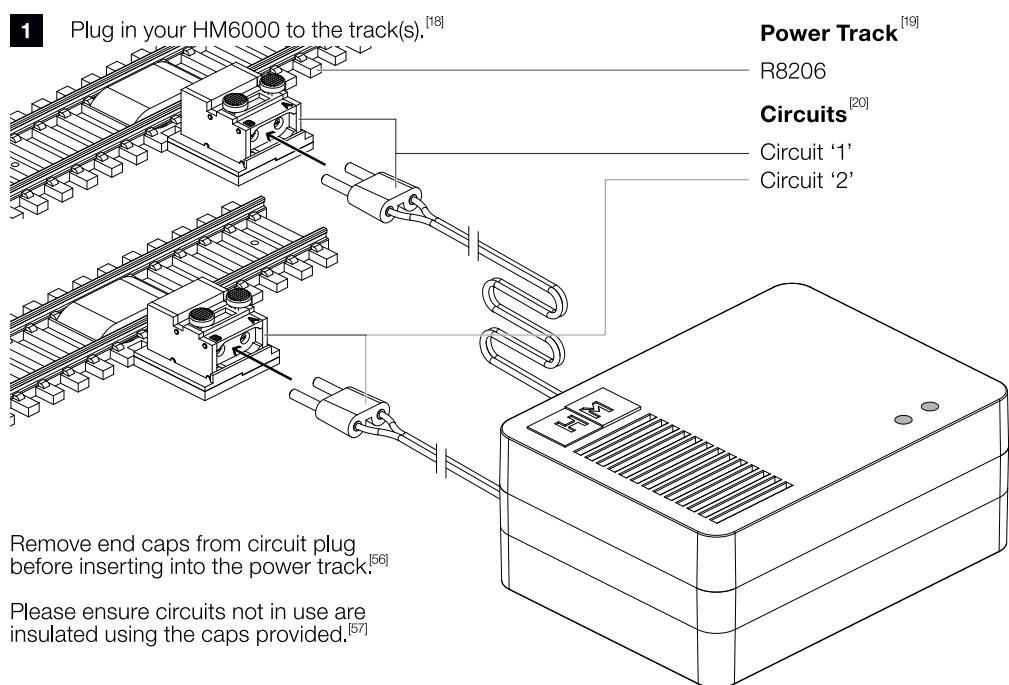

## Quick Start Guide<sup>[1]</sup>

**3** Download the HM | DC application.<sup>[25]</sup>

- Scan the QR code with a compatible Android or IOS device.<sup>[26]</sup>
- On the Hornby website, touch on the relevant app store<sup>[27]</sup> button.
- Touch on 'GET' or 'Install' next to the HM | DC app icon and follow the on-screen instructions.<sup>[28]</sup>
- Open the HM | DC application on your device to get started.<sup>[29]</sup>

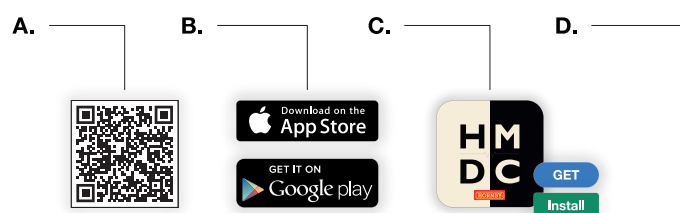

**4** Connect your HM6000 to HM | DC.<sup>[30]</sup>

- Ensure your Power LED is solid 'Red', if not refer to Step [2] of 'Initial setup'.<sup>[31]</sup>
- On your compatible device you wish to use, ensure that your Bluetooth is turned on.<sup>[32]</sup>
- Open the application and follow the initial setup process, ensuring you allow HM | DC to access and use Bluetooth on your device.<sup>[33]</sup>
- Once initial setup is complete, the Bluetooth connection LED should be solid 'Blue'.<sup>[34]</sup>

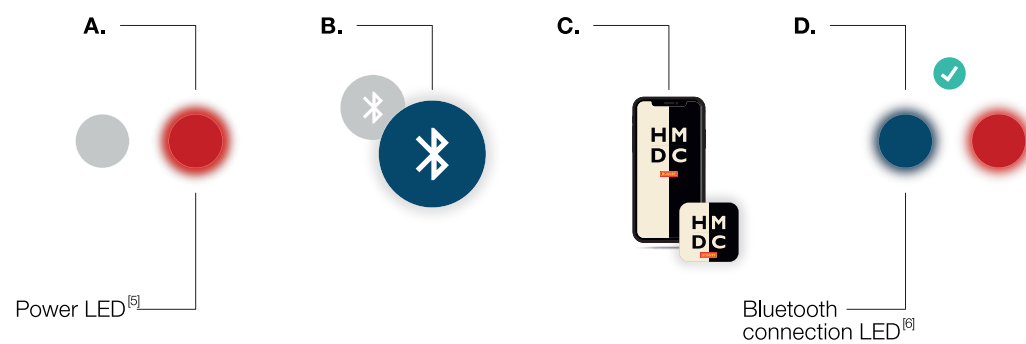

## Getting to know the controls <sup>[35]</sup>

- Calibrating your new control system. <sup>[36]</sup>

- 1 Place an analogue locomotive onto the track connected to Circuit '1' of your HM6000. <sup>[37]</sup>

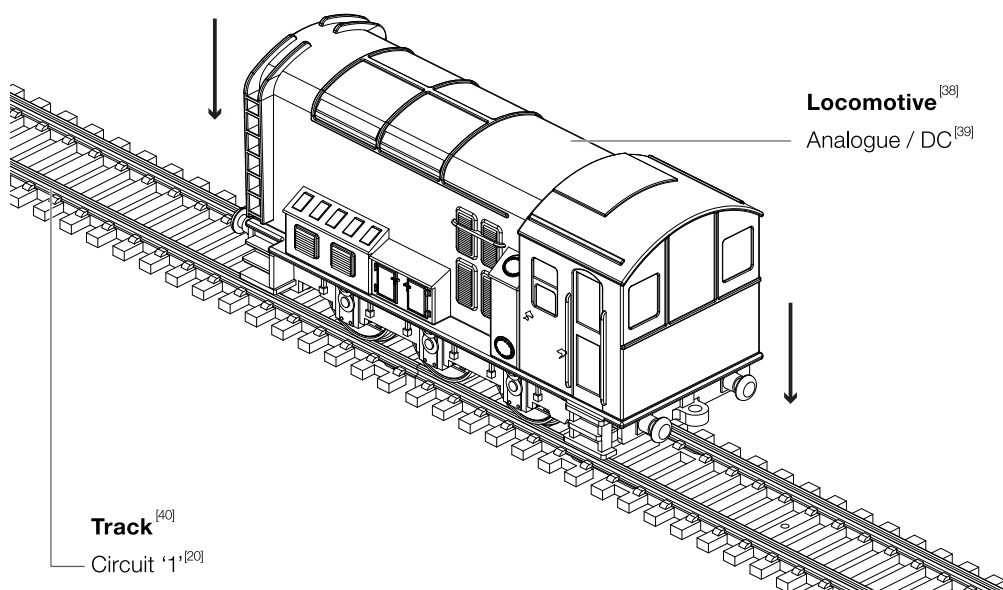

- 3 Use your finger to drag the speed slider on Circuit '1' from left to right until your loco is moving. Note the direction of locomotive travel (left or right?). <sup>[45]</sup>

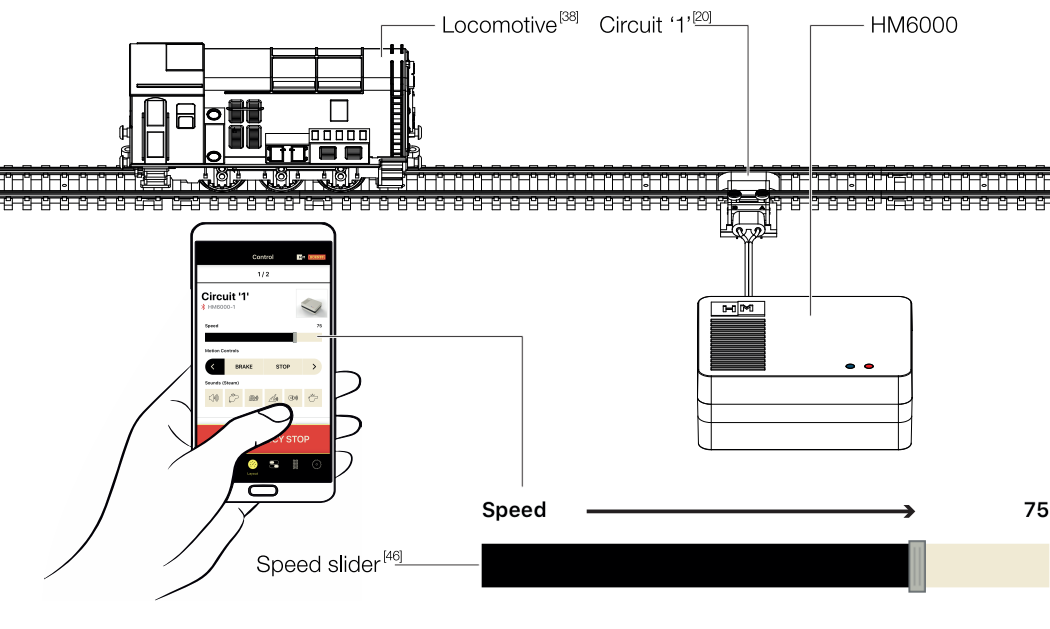

## FCC Warning <sup>[49]</sup>

- This device complies with part 15 of the FCC Rules. Operation is subject to the following two conditions: <sup>[50]</sup>

(1) This device may not cause harmful interference, and (2) this device must accept any interference received, including interference that may cause undesired operation. <sup>[51]</sup>

Any changes or modifications not expressly approved by the party responsible for compliance could void the user's authority to operate the equipment. <sup>[52]</sup>

This equipment has been tested and found to comply with the limits for a Class B digital device, pursuant to part 15 of the FCC Rules. These limits are designed to provide reasonable protection against harmful interference in a residential installation. This equipment generates uses and can radiate radio frequency energy and, if not installed and used in accordance with the instructions, may cause harmful interference to radio communications. However, there is no guarantee that interference will not occur in a particular installation. If this equipment does cause harmful interference to radio or television reception, which can be determined by turning the equipment off and on, the user is encouraged to try to correct the interference by one or more of the following measures: <sup>[53]</sup>

- Reorient or relocate the receiving antenna.
- Increase the separation between the equipment and receiver.
- Connect the equipment into an outlet on a circuit different from that to which the receiver is connected.
- Consult the dealer or an experienced radio/TV technician for help. <sup>[54]</sup>

The antenna(s) used for this transmitter must be installed to provide a separation distance of at least 20 cm from all persons and must not be collocated or operating in conjunction with any other antenna or transmitter, end-users must be provided with transmitter operation conditions for satisfying RF exposure compliance. <sup>[55]</sup>

- 2 Place yourself with the entire layout in front of you, ensure the HM | DC app is open and you have the 'Control' tab selected. <sup>[41]</sup>

## Device <sup>[42]</sup>

The 'Control' screen is your circuit controls <sup>[43]</sup>

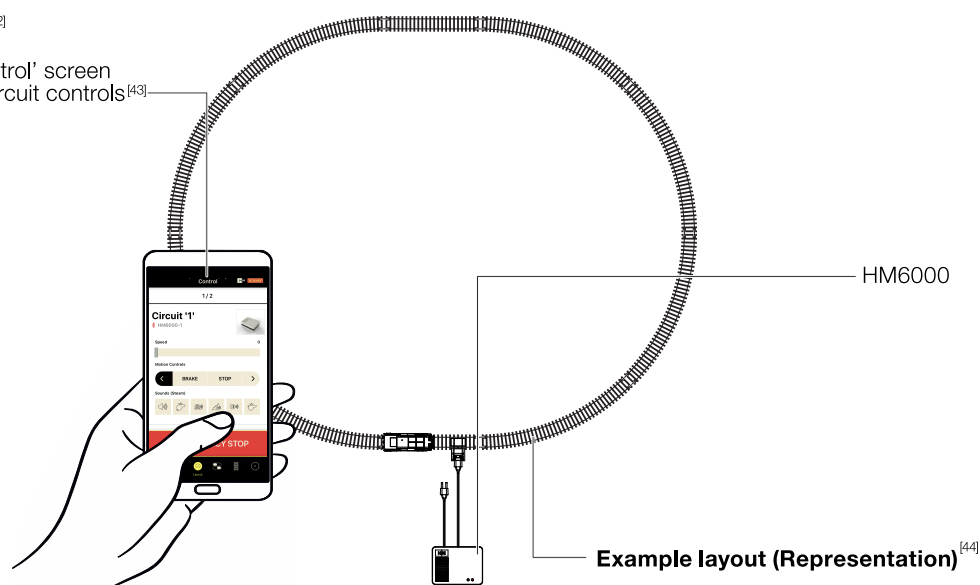

- 4 Does the locomotive direction match the selected directional button on the 'Control' screen of the app? If not, then remove the circuit plug from the power track section, turn it over and plug it back in. Repeat steps [1] - [4] for each of your other circuits; making sure all of your locomotives travel in the same direction around the circuits, regardless of which way the locomotives are facing. <sup>[48]</sup>

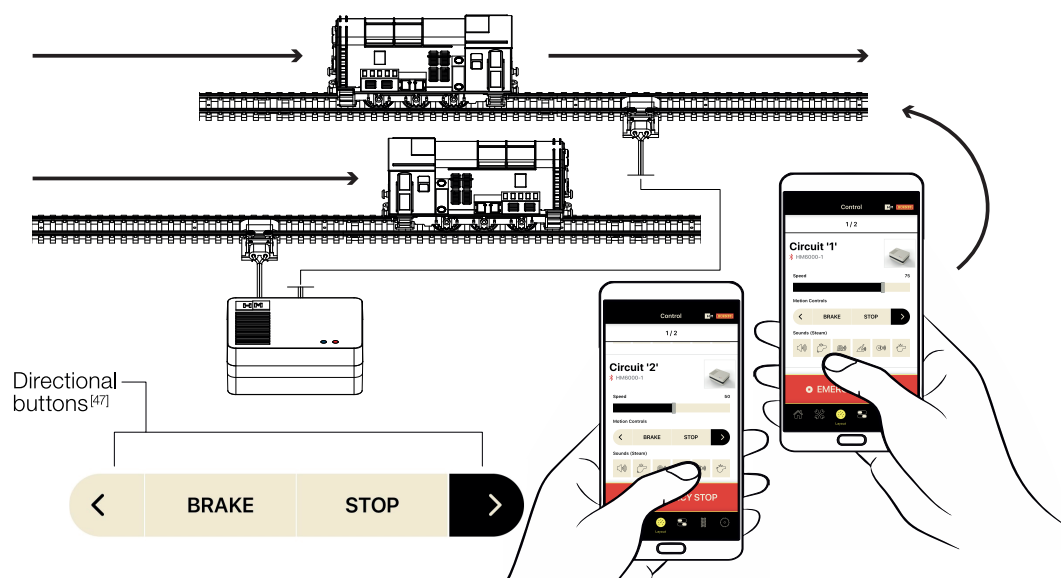

## Drilling Template

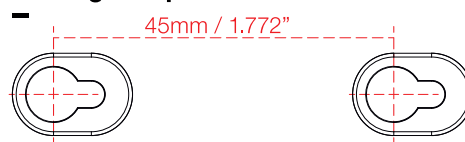

Manufactured by:  
**HORNBY HOBBIES LTD**  
Westwood Industrial Estate,  
Margate, Kent, CT9 4JX,  
United Kingdom  
+44(0)1843 233525

EU Authorised Representative:  
**HORNBY ITALIA S.r.l**  
Viale dei Cedri, 1  
52/AG, Castel Mella (BS),  
Italy, 25030  
+39 0367 501292  
customerservices.it@hornby.com

EN English digital version available here:  
FR La version digitale française est disponible ici:  
IT La versione digitale in italiano è disponibile qui:  
DE Deutsche digitale Version hier verfügbar:  
ES Versión digital en español disponible aquí:



www.hornby.com 4/1622 customerservices.uk@hornby.com  
This instruction sheet or part thereof may not be copied, duplicated, amended or circulated in any form whatsoever without written permission from Hornby Hobbies Ltd. © Hornby Hobbies Ltd.



Radiation Frequency: 2402MHz-2480MHz,  
Power ≤10mW

HM6000 - Quick Start Guide