

Getting to know the HM6010^[2]
Your new Bluetooth accessory controller.^[3]

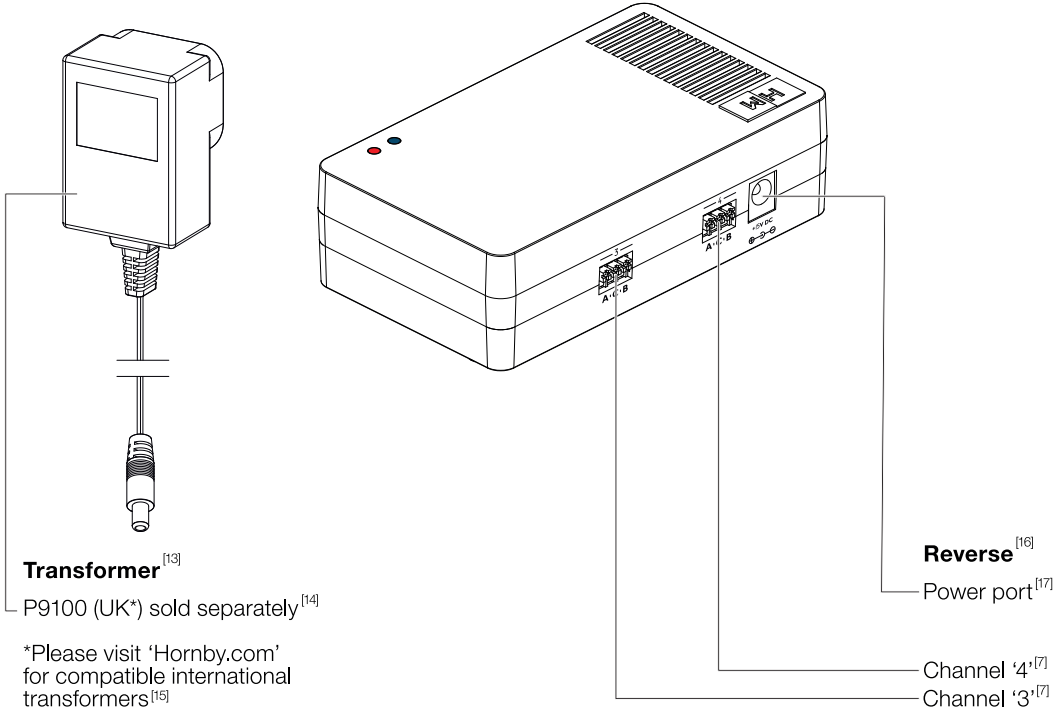

Initial setup^[18]
Your quick step guide^[19]

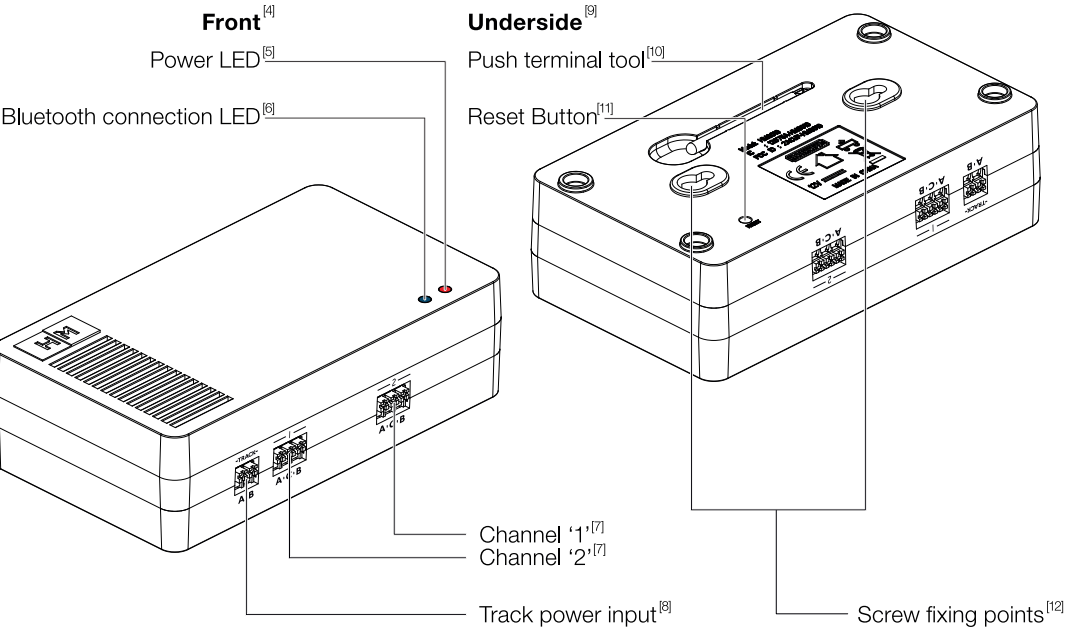
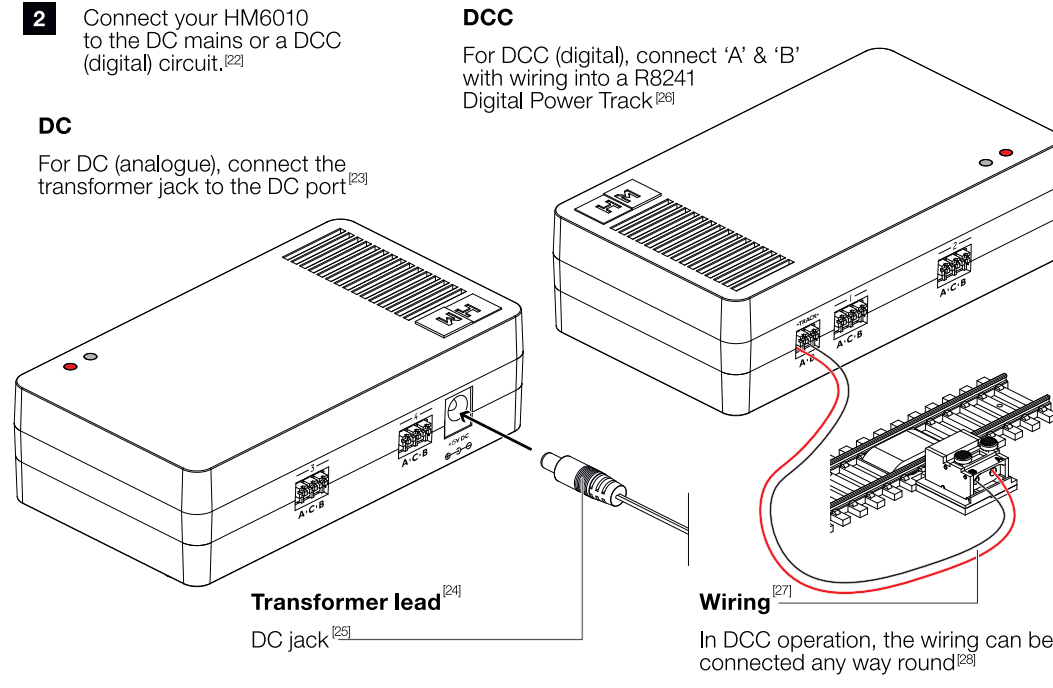
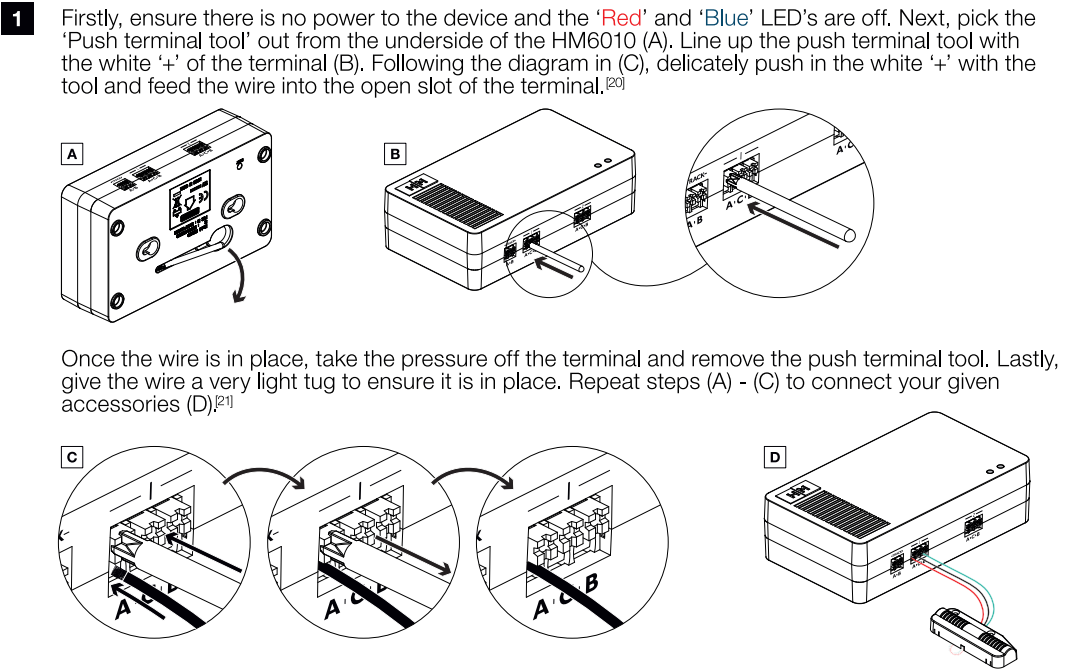

Quick Start Guide^[1]

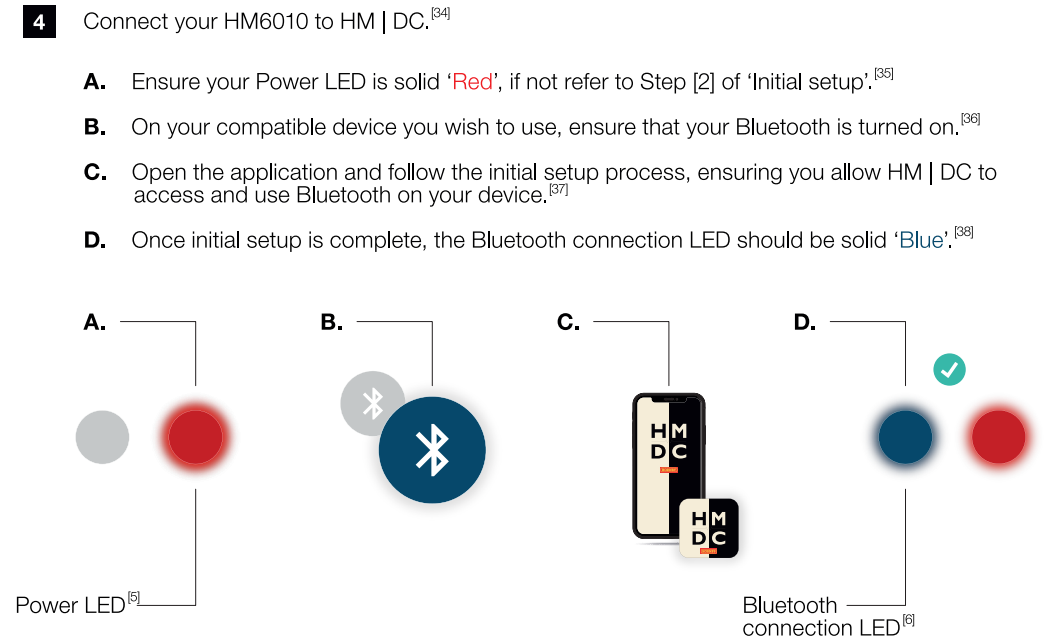
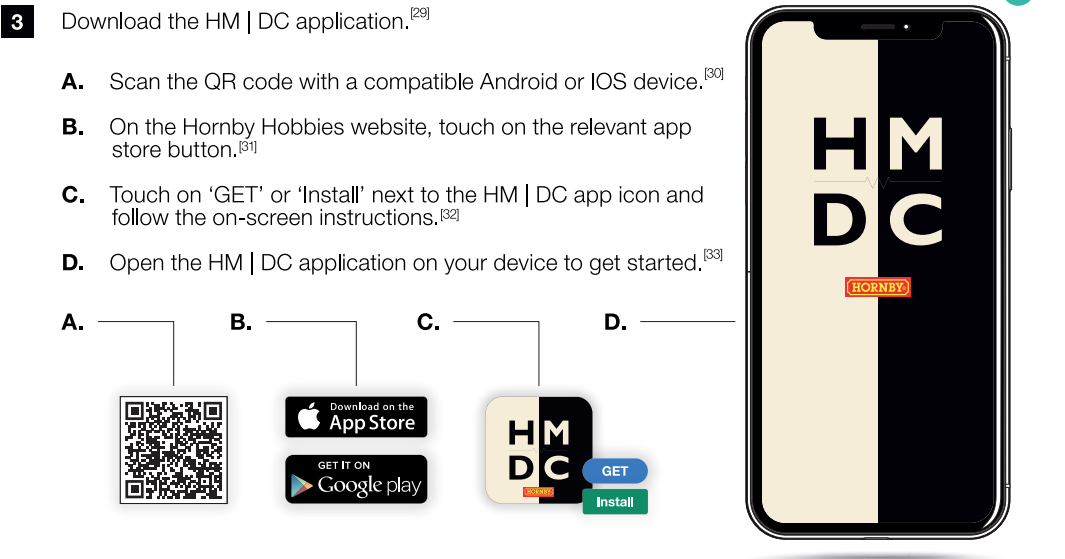

Basic wiring configurations

Suggestions for wiring your accessories into HM6010.

1 Point motors

Wire in the coloured wires from a Hornby point motor (R8243 & R8014) as follows [1]: 'Red' to 'A'(<), 'Black' to 'C'(common +) & 'Green' to 'B'(>).

In the HM | DC app device settings, select the 'Point' option for the channel matching the terminal on the HM6010 you have wired your accessory into.

Point motors can be wired into channel/terminal '1', '2', '3' & '4'.

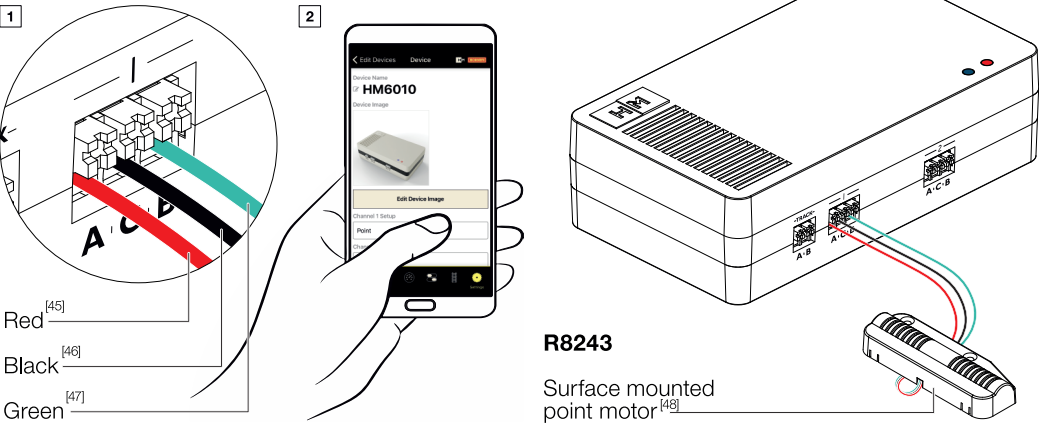

R8243
Surface mounted point motor

3 Street lighting

Wire in the coloured wires from a street light with a simple on/off function as follows [1]: 'Red' to 'C'(common +) & 'Black' to 'A'(<).

In the HM | DC app device settings, select the 'Lights' option for the channel matching the terminal on the HM6010 you have wired your accessory into.

Street lighting can be wired into channel/terminal '1', '2', '3' & '4'.



Street lighting
Example street light

FCC Warning

This device complies with part 15 of the FCC Rules. Operation is subject to the following two conditions:

(1) This device may not cause harmful interference, and (2) this device must accept any interference received, including interference that may cause undesired operation.

Any changes or modifications not expressly approved by the party responsible for compliance could void the user's authority to operate the equipment.

This equipment has been tested and found to comply with the limits for a Class B digital device, pursuant to part 15 of the FCC Rules. These limits are designed to provide reasonable protection against harmful interference in a residential installation. This equipment generates uses and can radiate radio frequency energy and, if not installed and used in accordance with the instructions, may cause harmful interference to radio communications. However, there is no guarantee that interference will not occur in a particular installation. If this equipment does cause harmful interference to radio or television reception, which can be determined by turning the equipment off and on, the user is encouraged to try to correct the interference by one or more of the following measures:

- Reorient or relocate the receiving antenna.
- Increase the separation between the equipment and receiver.
- Connect the equipment into an outlet on a circuit different from that to which the receiver is connected.
- Consult the dealer or an experienced radio/TV technician for help.

The antenna(s) used for this transmitter must be installed to provide a separation distance of at least 20 cm from all persons and must not be collocated or operating in conjunction with any other antenna or transmitter, end-users must be provided with transmitter operation conditions for satisfying RF exposure compliance.

2 Signal Lighting

Wire in the coloured wires from a Hornby signal light (R406) as follows [1]: 'Red' to 'A'(<), 'Green' to 'C'(common +) & 'Black' to 'B'(>).

In the HM | DC app device settings, select the 'Signal' option for the channel matching the terminal on the HM6010 you have wired your accessory into.

Signal lighting can be wired into channel/terminal '1', '2', '3' & '4'.

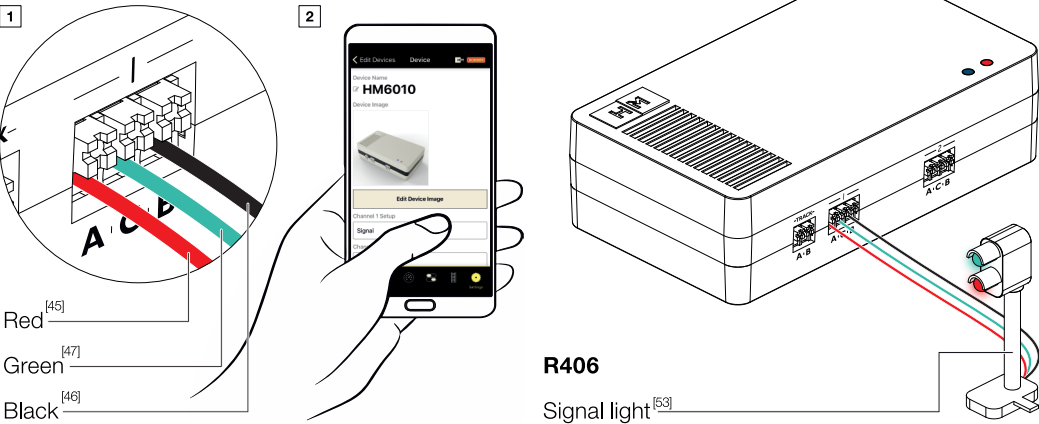

R406
Signal light

4 Motor driven accessories

Wire in the coloured wires from a motor driven accessory, for example a Hornby turntable (R070) as follows [1]: 'Red' to 'C'(common +) & 'Black' to 'A'(<).

In the HM | DC app device settings, select the 'Turntable' option on Channel '4' Setup.

Motor driven accessories can **only** be wired into channel/terminal '4'.

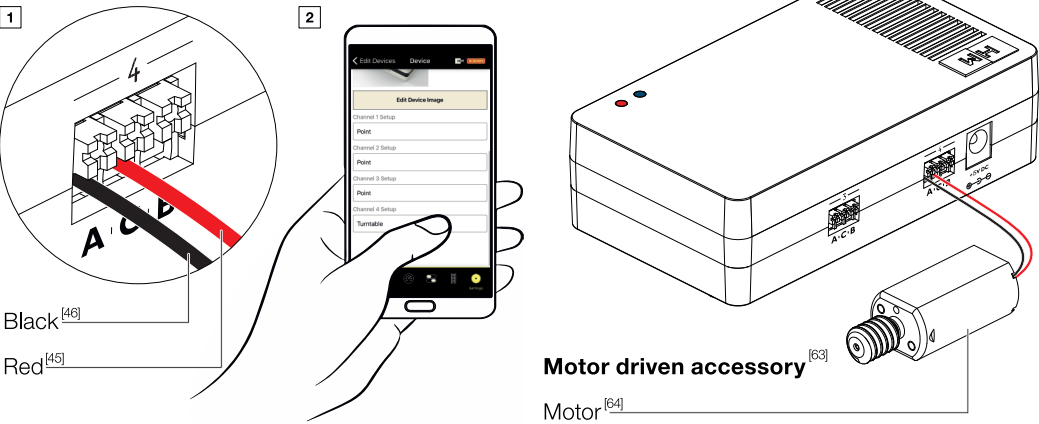

Motor driven accessory
Motor

Drilling Template

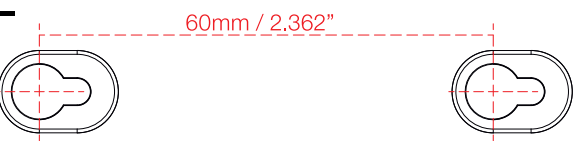

Manufactured by:
HORNBY HOBBIES LTD
Westwood Industrial Estate,
Margate, Kent, CT9 4JX,
United Kingdom
+ 44(0)1843 233525
customerservices.uk@hornby.com

EU Authorised Representative:
HORNBY ITALIA S.r.l
Viale dei Gediuti,
52/A6, Castel Mella (BS),
Italy, 25030
+ 39 0367501292
customerservices.it@hornby.com

EN English digital version available here:
FR La version digitale française est disponible ici:
IT La versione digitale in italiano è disponibile qui:
DE Deutsche digitale Version hier verfügbar:
ES Versión digital en español disponible aquí:



www.hornby.com 4/1623B
This instruction sheet or part thereof may not be copied, duplicated, amended or circulated in any form whatsoever without written permission from Hornby Hobbies Ltd. © Hornby Hobbies Ltd.



Model: HM6010
FCC ID: 2ACUF-HM6010
IC: 12075A-HM6010
Radiation Frequency: 2402MHz-2480MHz,
Power ≤10mW